

The goal of Master Planning is to develop comprehensive, equitable, integrated and visionary high school campus master plans with authentic school community engagement.



## MADISON HIGH SCHOOL MASTER PLAN

Portland Public Schools | Opsi Architecture + Dao

# MASTER PLAN COMMITTEE 03

# AGENDA

## Review Previous Workshops

Review Outcomes of MPC 01

## Understanding the Program

Visual Program

Relationships - Education Vision

## Interactive Vision Work Session

Build a School

Express Vision from MPC 02

Report Back

Rank Options

## Public Comment

## Next Steps

Programming Interviews

Next Generation Schools Symposium - April 09

Educators Workshop 02 - April 11

Tours

Public Outreach



*“Describe the Madison community and what makes it special to you”*

# MASTER PLAN COMMITTEE 02



Building Tour



Vision Work Session

# MASTER PLAN COMMITTEE 02



- EDIT TEXT

# MASTER PLAN COMMITTEE 02



Amazingly Inclusive  
 Diverse  
 Innovative  
 Connected - plugged in - knowing adults  
 Problem Solvers  
 Resilient  
 Caring  
 Jugglers - many responsibilities  
 Evolving  
 Savvy / street smart  
 Aspirational  
 Untapped  
 Locally place based - hyper local  
 international / worldly

# MASTER PLAN COMMITTEE 01



DIVERSE  
 COMMITTED  
 COMMUNITY  
 GRITTY/URBAN  
 RESILIENT  
 CREATIVE  
 INCLUSIVE  
 POTENTIAL  
 WELCOMING  
 OVERLOOKED  
 EMPOWERING  
 RESOURCEFUL  
 HIDDEN GEM

# MASTER PLAN COMMITTEE 02



Present	Future <sup>3</sup>
- Proximity for many students	- Open spaces, security cameras (inside/out)
- Safety Concerns - No security cameras	- More space to exercise flexible spaces for all
- Lack of space for students not in sports who want to use the gym, fields, etc.	
- Friendly, helpful, united environment, caring community	
- Diversity	

# MASTER PLAN COMMITTEE 02

community

belonging

Students

safe

community

commons

Natural Light

makerspace

Natural Light

interactive

small groups

Natural Light

athletics/wellness

architecture

Grow PDX

outdoor learning

inclusive

library

Natural Light

learning suites

equal

flexible

classroom

diverse

administration

computer lab

flexible

labs / science

challenging

performance

community

flexible

Family

4

Madison High School Master Plan  
Master Plan Committee Meeting #2 03.07.16

OPSIS architecture | architecture

A 21st century <sup>A</sup>  
inclusive learning  
community that is  
challenging, diverse,  
supportive and values  
students, staff and  
families.

No leftovers  
Repurposed items  
accepted

Source of  
~~Source~~  
Knowledge

Safety

2nd Home



# MASTER PLAN COMMITTEE 02

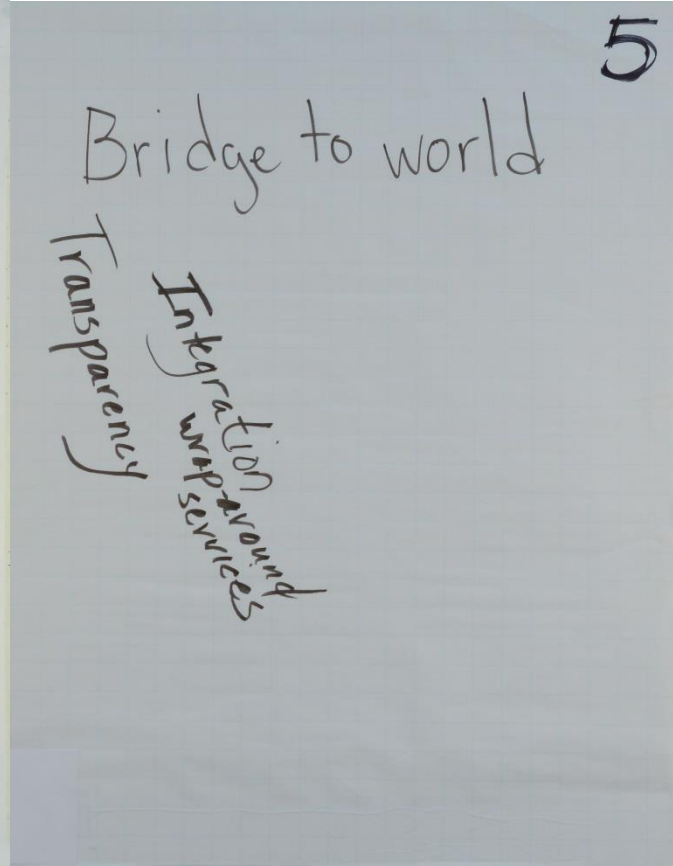

# MASTER PLAN COMMITTEE 02



DIVERSE — LANGUAGE  
 — COMMUNITY  
 — INTERESTS

SUPPORT — EDUCATIONAL  
 — PHYSICAL

OPPORTUNITY

VISIBILITY IN COMMUNITY

WELCOMING STAFF

# VISUAL PROGRAM

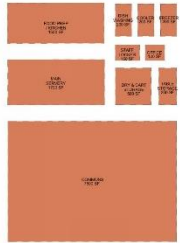

STUDENT CENTER / COMMONS

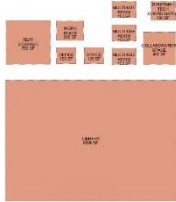

LIBRARY



CUSTODIAL

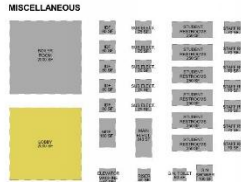

MISCELLANEOUS

SUPPORT

WRAP-AROUND SERVICE PROVIDERS



PARTNER & COMMUNITY USES



PARTNER & COMMUNITY USES & WRAP-AROUND SERVICE PROVIDERS



EXTENDED LEARNING

INSTRUCTIONAL

FINE & VISUAL ARTS

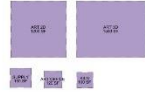

BAND / ORCHESTRA



CHOIR



THEATER / DANCE



FINE ARTS

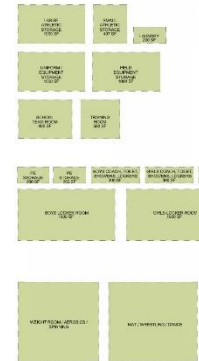

ATHLETICS

STUDENT TESTING



COUNSELING CENTER



ADMINISTRATION

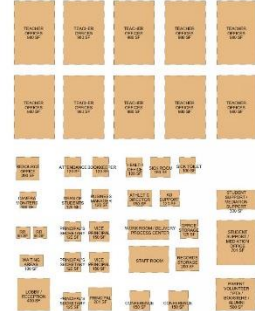

EDUCATION SUPPORT

EMERGING LANGUAGE LEARNING



STUDENT GOVERNMENT



SPECIAL EDUCATION

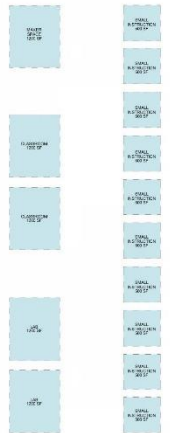

CAREER PREP

SMALL INSTRUCTION

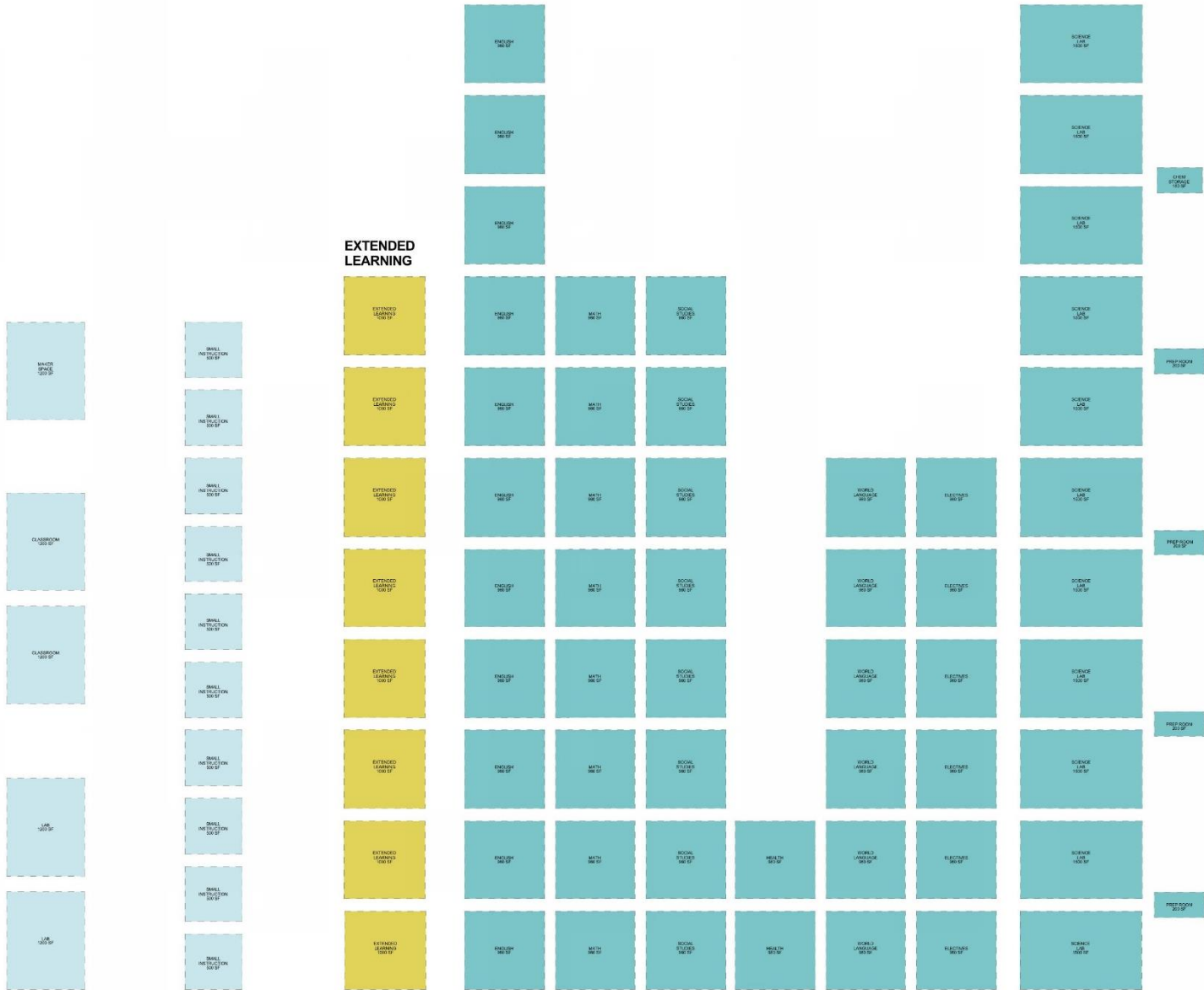

CAREER  
PREP

SMALL  
INSTRUCTION

INSTRUCTIONAL

# CLASSROOMS

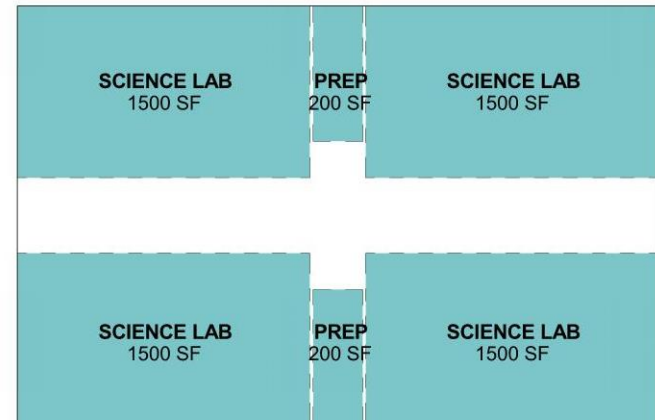
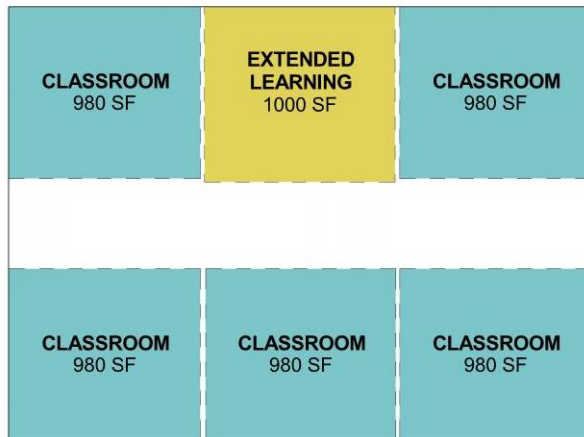

# LEARNING ENVIRONMENTS

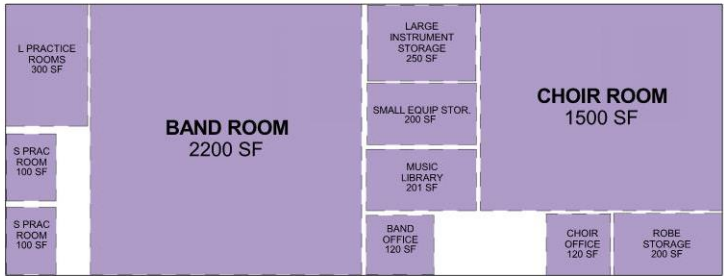
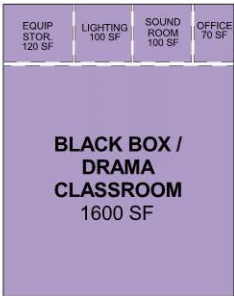
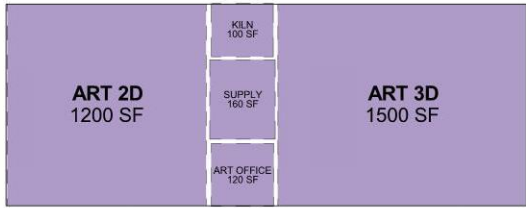

# FINE AND PERFORMING ARTS

# ATHLETICS

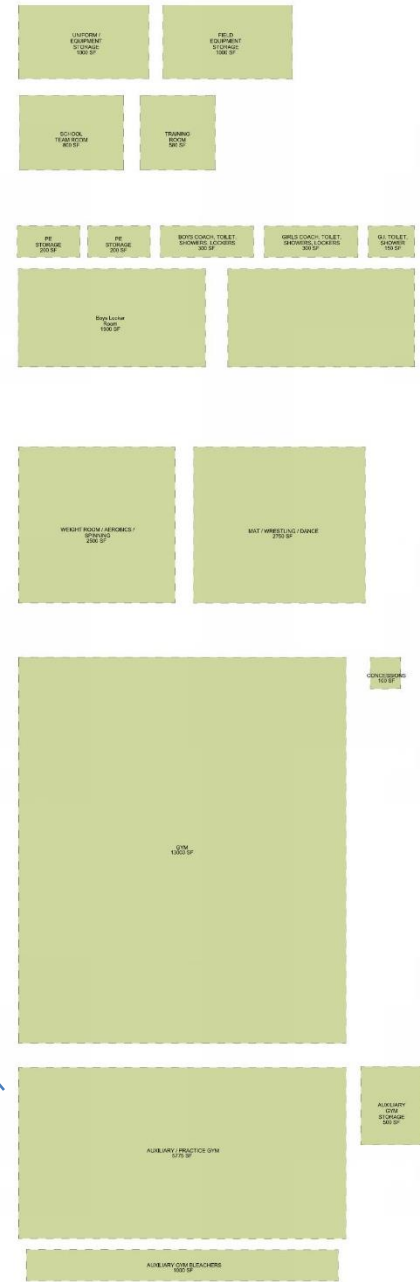
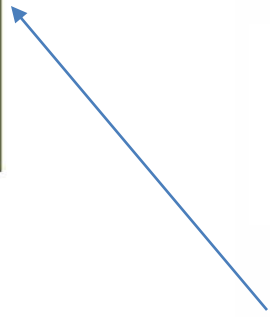
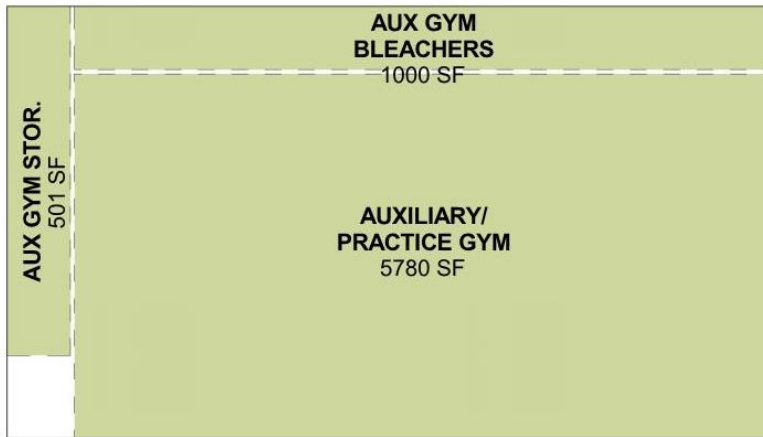

# ATHLETICS

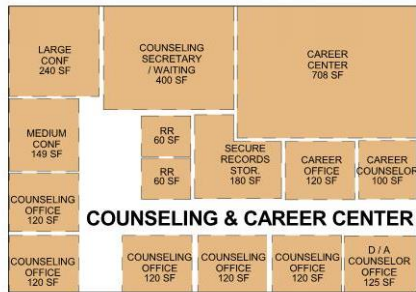

# ED SUPPORT - ADMINISTRATION



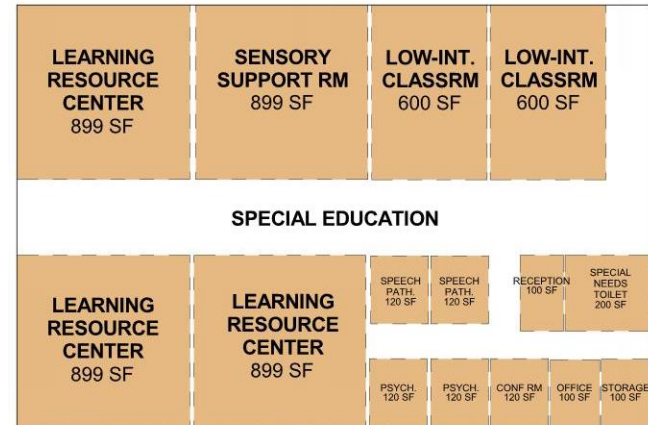
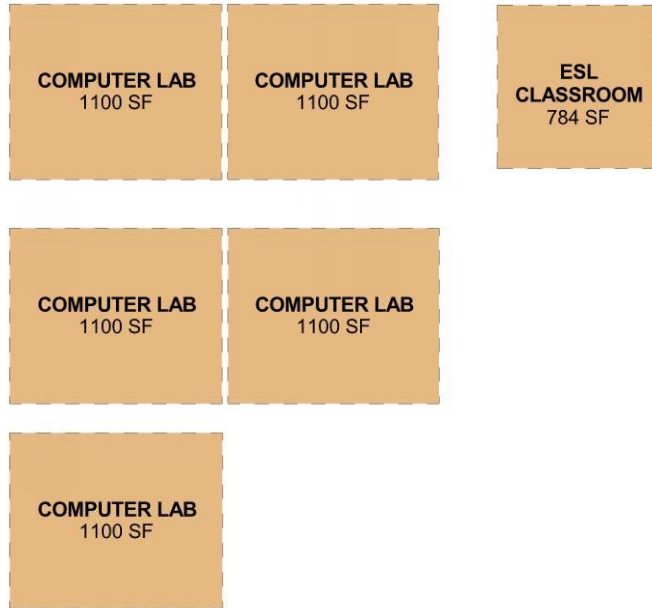

# EDUCATION SUPPORT – COMPUTER / SPED

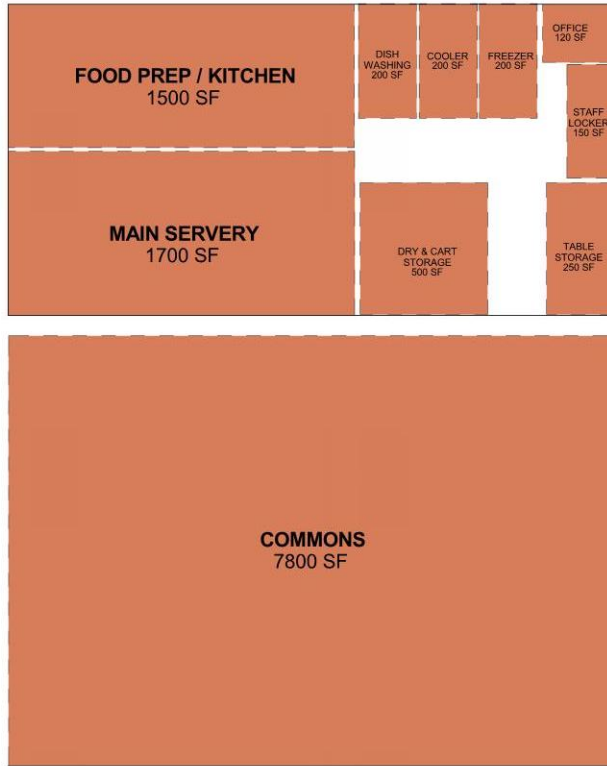

# COMMONS

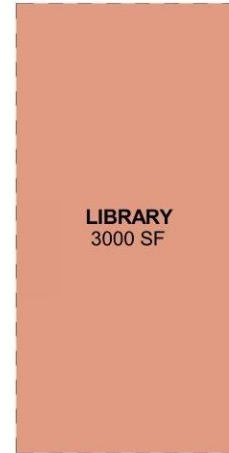
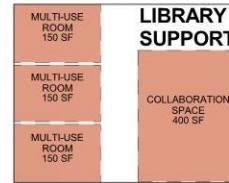
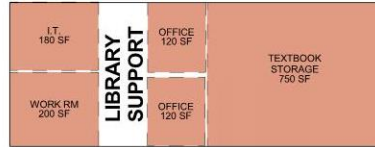

LIBRARY



# PARTNER AND COMMUNITY SPACES

# PPS EDUCATIONAL SPECIFICATIONS

## PPS Comprehensive High School(s) Area Program

### SUMMARY

Preferred to required: Optional: not required or applied to total of required

AREA <sup>1,2</sup>	REQUIRED	PREFERRED / OPTIONAL		S.F. Total
	Quantity	Quantity	S.F. Room	
<b>COMPREHENSIVE HIGH SCHOOL PROGRAM - TEACHING STATIONS</b>				
General Education (Gen-Ed) Classrooms	41			48,180
Science Labs	11			16,500
Fine & Performing Arts (Drama, Theater)	4			21,350
Career Preparation/CTE <sup>3</sup>	3			6,000
Athletics (includes area for P.E. instruction)	3			35,580
Education Support <sup>4</sup> (SPED, ELL)	2			67,400
Smaller Instructional Spaces	10			5,000
<b>Sub-Total Required Teaching Stations</b>	<b>74</b>			<b>200,010</b>
Community Partners <sup>5</sup>				1,200
Wrap-Around Service Providers <sup>5</sup>				4,700
<b>Sub-Total</b>				<b>5,900</b>
<b>SUB-TOTAL COMPREHENSIVE HIGH SCHOOL REQUIRED AREA</b>				<b>205,910</b>
<b>Net to Gross Ratio of 36% <sup>6</sup></b>				<b>74,128</b>
<b>TOTAL COMPREHENSIVE HIGH SCHOOL REQUIRED</b>				<b>280,038</b>

#### Notes:

- <sup>1</sup> Area program for 1,700 student enrollment. Required program refers to the education program needed to meet graduation requirements. The area program includes spaces to accommodate course offerings reflected in credit hours typically taken by students
- <sup>2</sup> Areas identified in Area Program are more readily achieved in new construction; it is expected the area of rooms and spaces in existing buildings will vary from those of the area program to accommodate the floor plates and other structural limitations of existing buildings
- <sup>3</sup> Each Comprehensive High School will contain a minimum of 6,000 SF for career preparation/CTE/Maker Space
- <sup>4</sup> Includes Teacher Workrooms @ 10 teacher offices per workroom
- <sup>5</sup> Assumptions based upon current average area of partners/providers in high schools
- <sup>6</sup> Gross area includes walls, corridors and circulation areas; 36% net to gross for new construction; ratio for modernization projects will vary depending on extent of work

# PPS HIGH SCHOOL PLANNING PRINCIPLES

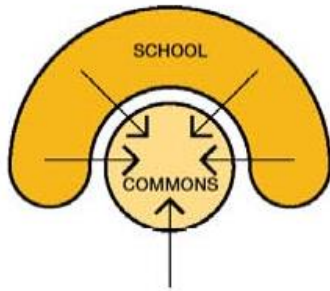

School "Heart"

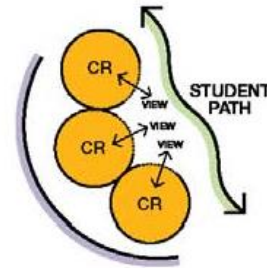

Transparent

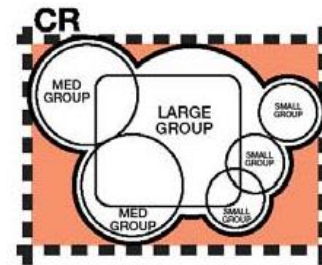

Variety

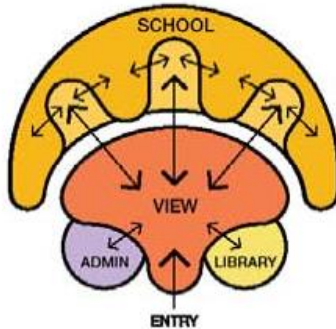

Viewable

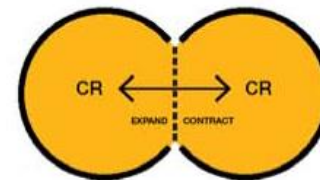

Flexible / Agile

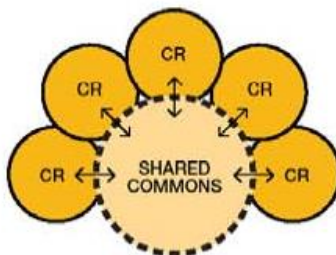

Learning Suite

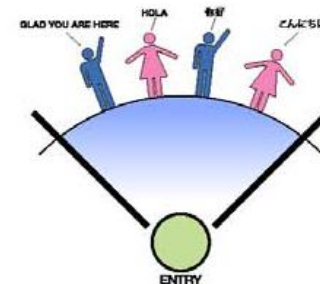

Entry

# EXISTING BUILDING ANALYSIS





NEIGHBORS



SKATE PARK



ROCKY BUTTE PARK VIEWS

GLEN HAVEN PARK VIEWS



PUBLIC VIEWS

BUS STOP



LEARNING

LEARNING

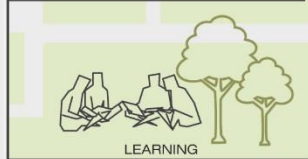

LEARNING



GREENERY VIEWS

GOLF COURSE



GARDENS

PUBLIC VIEWS

CITY VIEWS



82ND AVE.

MADISON COMMUNITY



FIELD



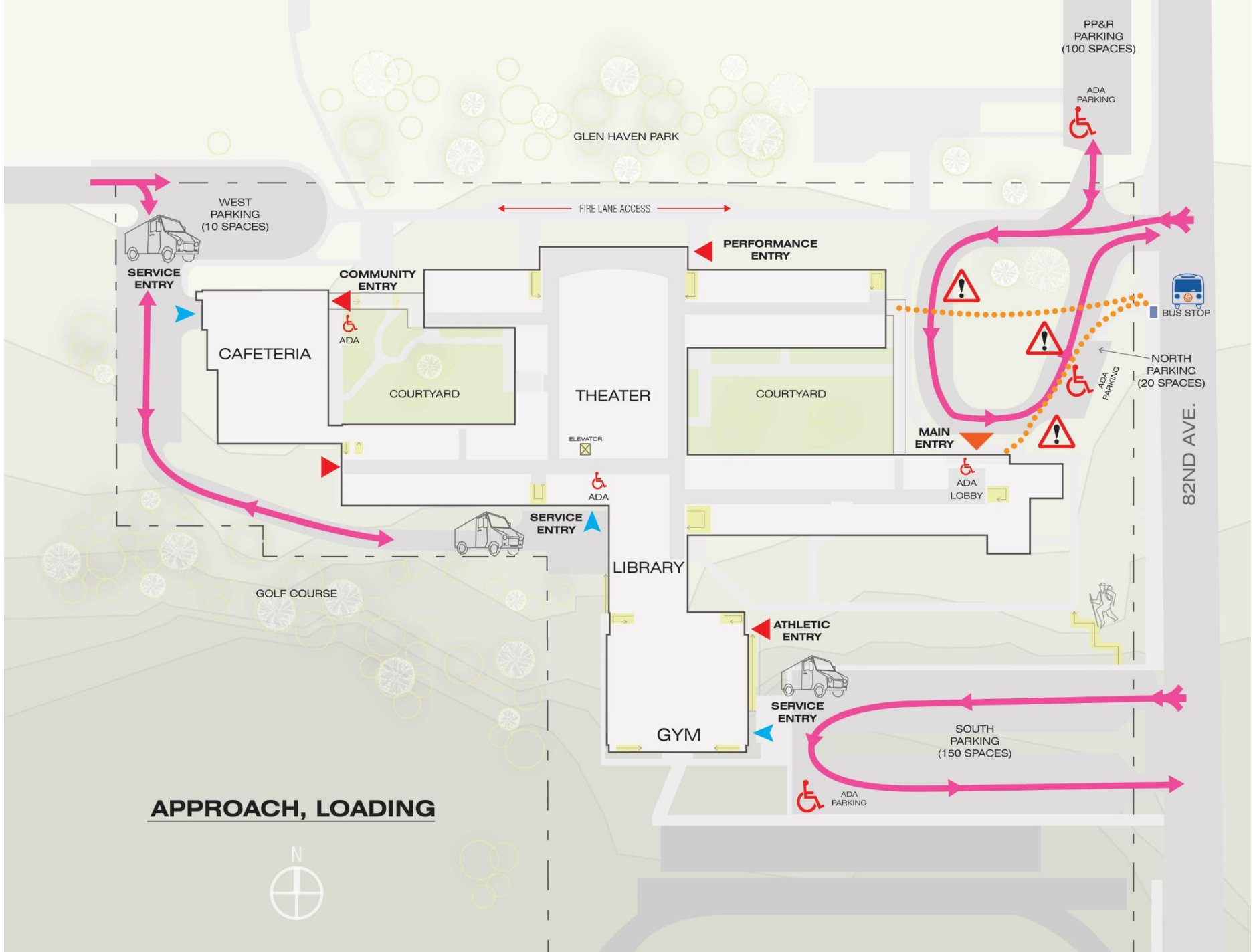

**APPROACH, LOADING**



GLEN HAVEN PARK

WEST PARKING  
(10 SPACES)

SERVICE ENTRY

CAFETERIA

COMMUNITY ENTRY



ADA

COURTYARD

THEATER

ELEVATOR



ADA

SERVICE ENTRY

LIBRARY

GOLF COURSE

GYM

ATHLETIC ENTRY

SERVICE ENTRY

SOUTH PARKING  
(150 SPACES)



ADA PARKING

PERFORMANCE ENTRY

COURTYARD

MAIN ENTRY



ADA LOBBY

ADA PARKING

PP&R PARKING  
(100 SPACES)

NORTH PARKING  
(20 SPACES)

82ND AVE.

BUS STOP

FIRE LANE ACCESS

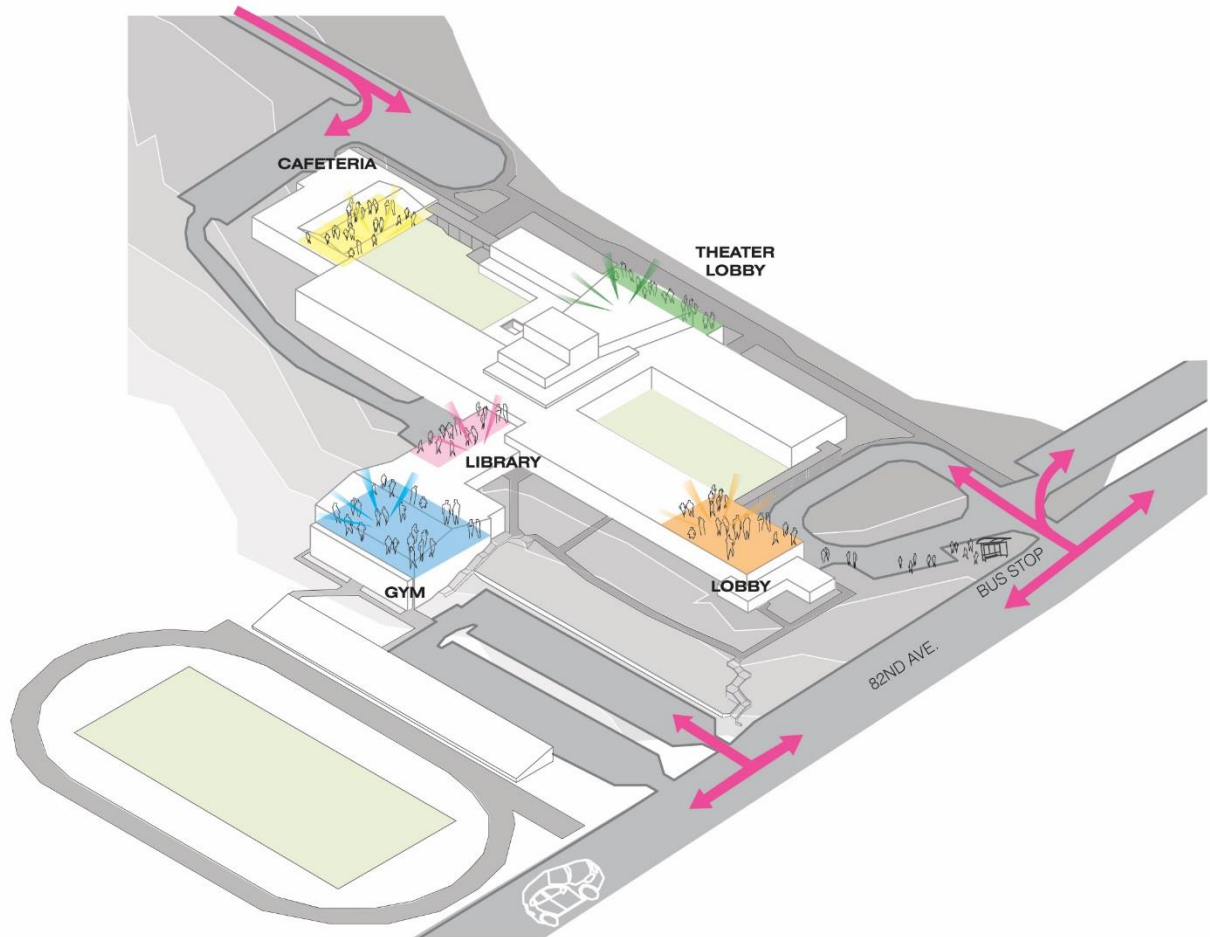

**VISIBILITY OF PUBLIC SPACES**

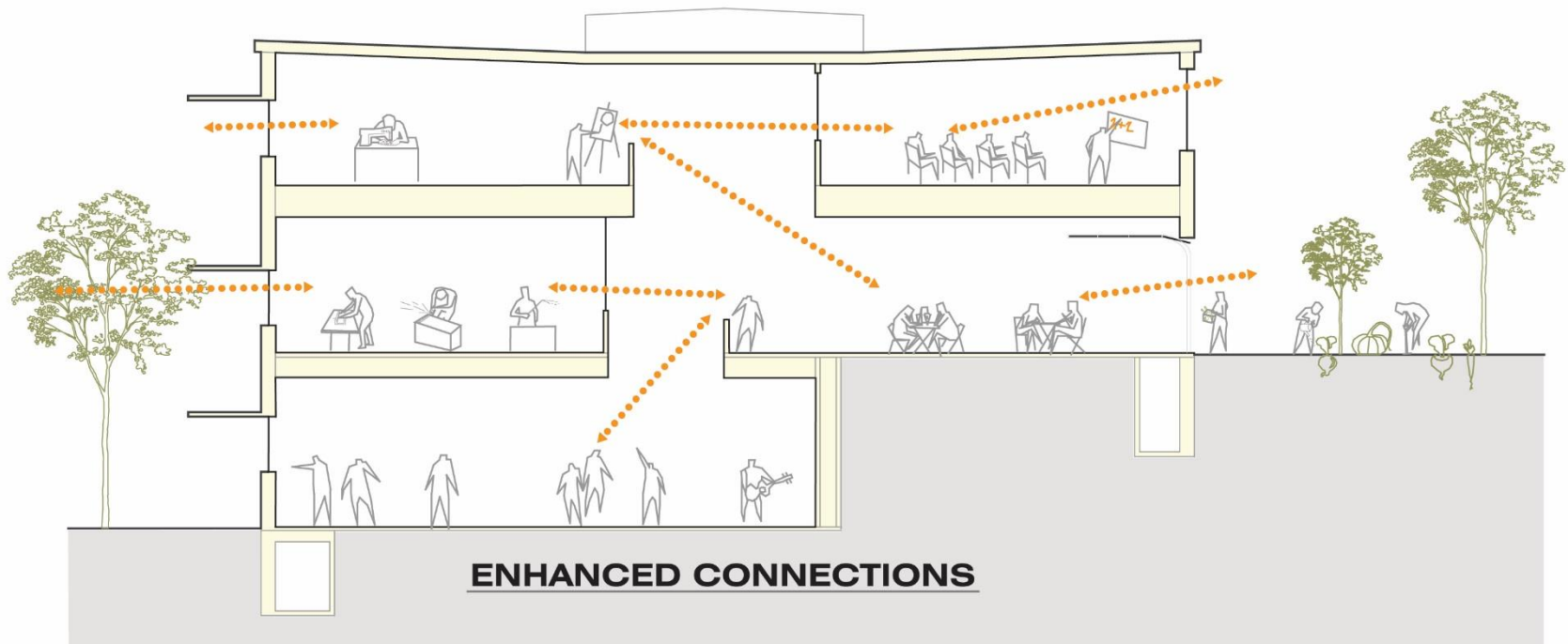
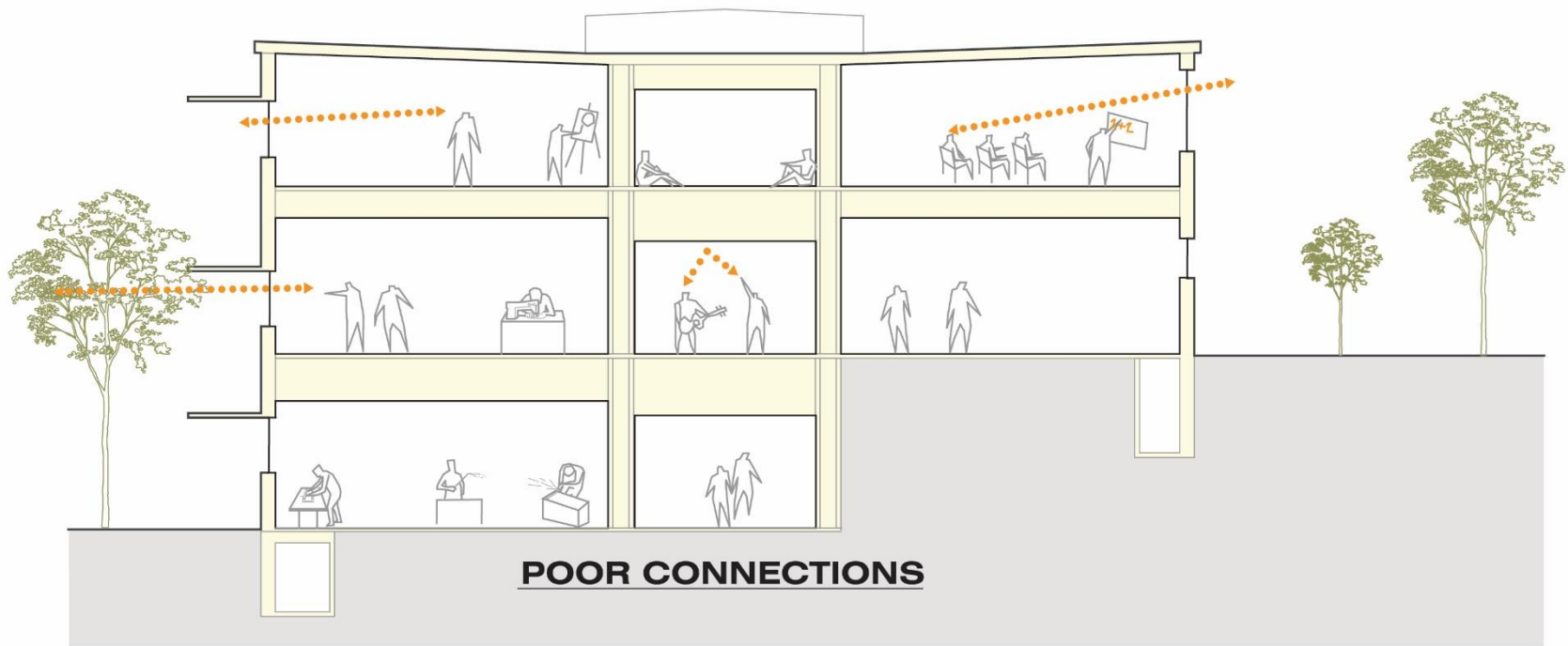

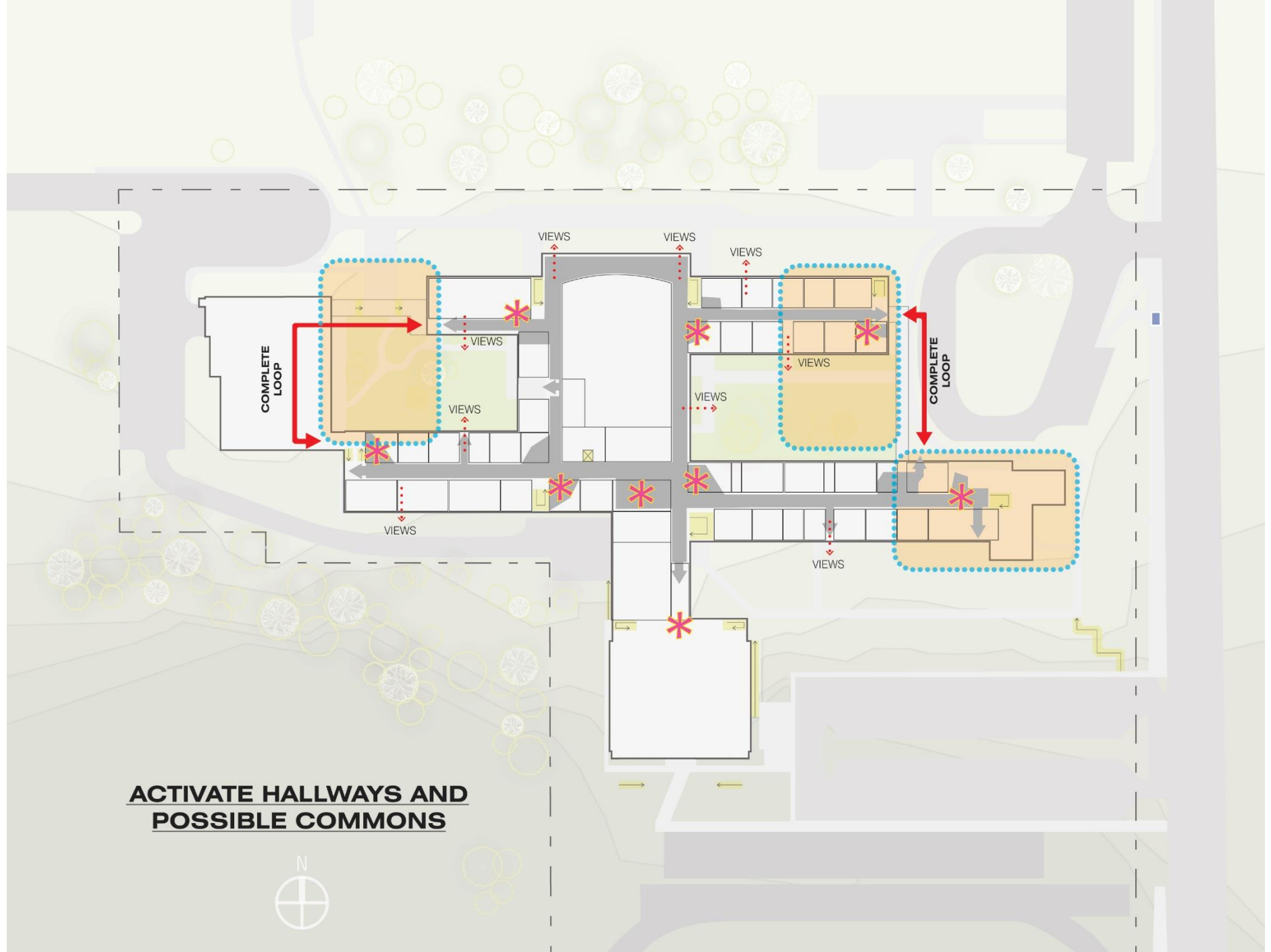

**ACTIVATE HALLWAYS AND  
POSSIBLE COMMONS**



# BUILDING ASSESSMENT

## Department

- ATHLETICS
- GROSS
- SUPPORT

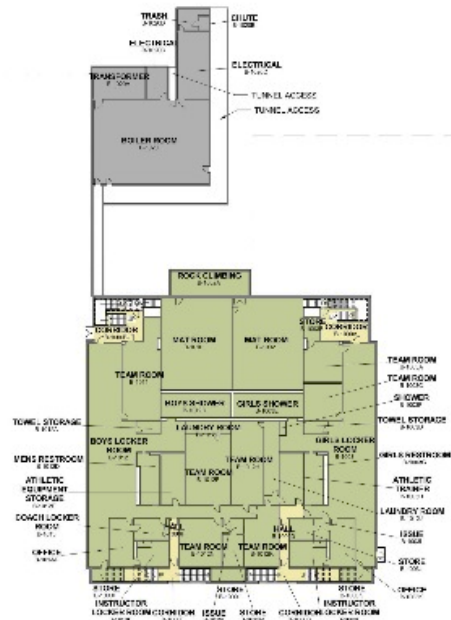

BASEMENT 1



BASEMENT 2

# BUILDING ASSESSMENT

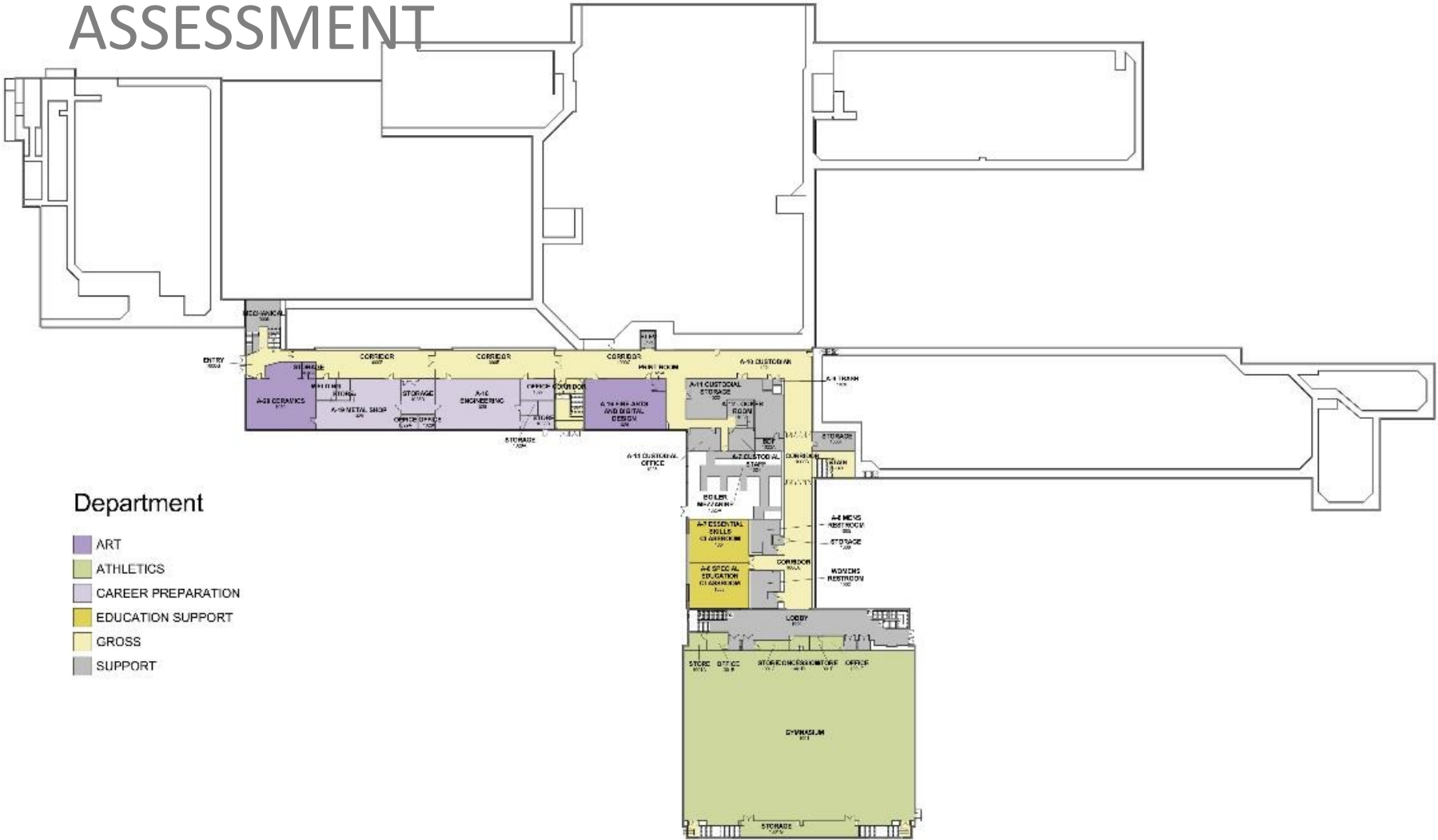

LOWER LEVEL



# PROGRAM ASSESSMENT

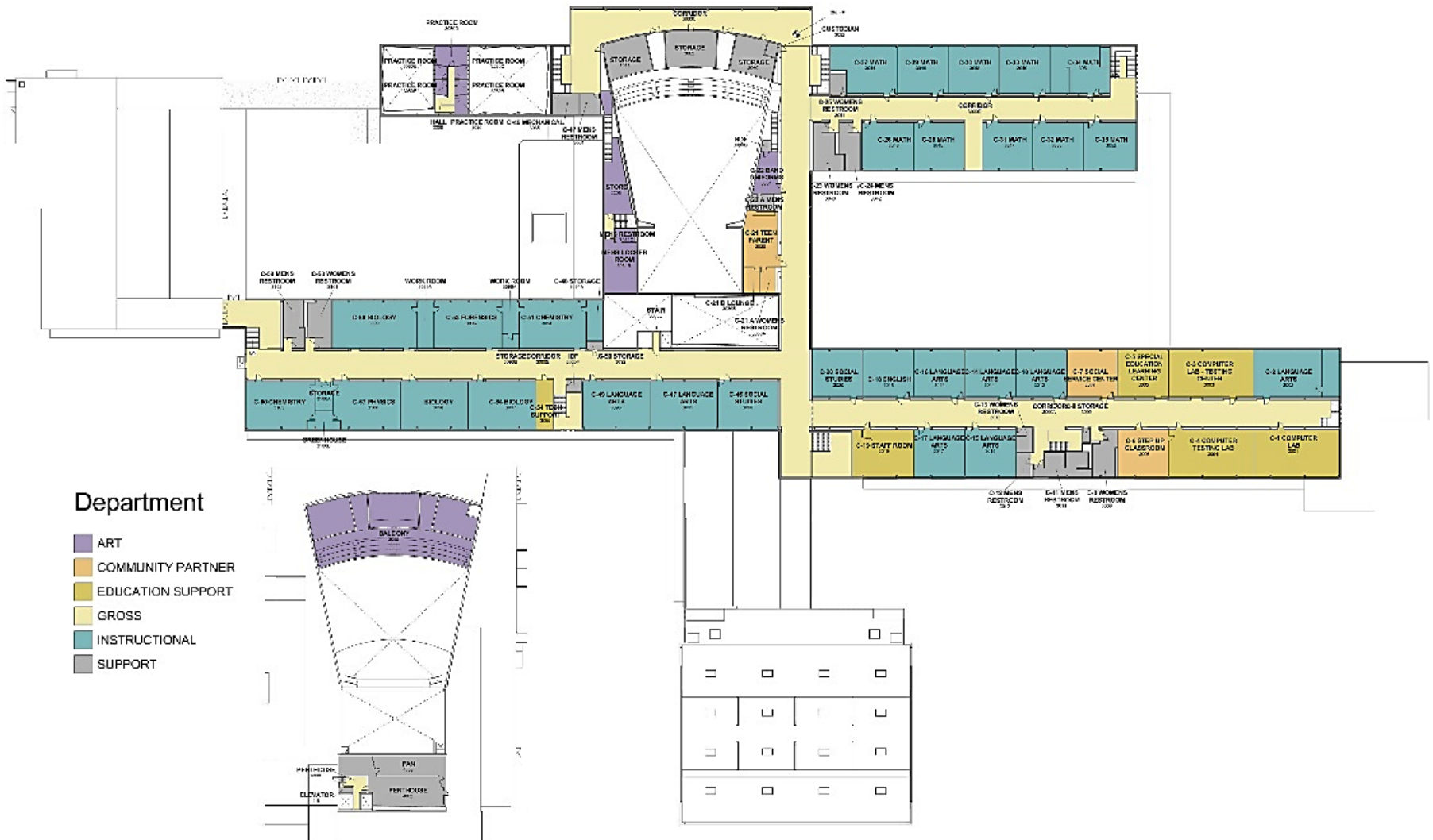

UPPER FLOOR LEVEL